

## Angle adapters

connection A

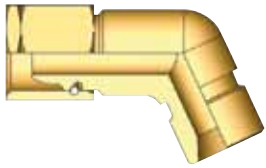

connection B

PN10

EN 560

- A ≙ MG
- angle: 115°
- B ≙ AGS

connection A

G 1/4 RH  
G 3/8 RH  
G 3/8 RH  
G 3/8 LH  
G 3/8 LH

connection B

G 1/4 RH  
G 1/4 RH  
G 3/8 RH  
G 3/8 LH  
M 14x1,5 RH

order no.

100005059  
100107051  
100107079  
100008089  
100008651

## Nuts

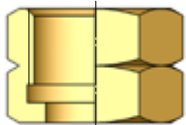

EN 560

connection

G 1/4 LH  
G 1/4 RH  
G 3/8 LH  
G 3/8 RH  
G 1/2 LH  
G 1/2 RH  
G 3/4 LH  
G 3/4 RH  
G 1 LH  
G 1 RH

order no.

951001000  
951000900  
951000800  
951000700  
951000600  
951000500  
951001600  
951001500  
951001400  
951001300

for nozzle  $\varnothing \geq 12,5$  mm:

G 1/2 LH  
G 1/2 RH

951019900  
951020000

## Nipples



DN

EN 560

### female connection

for nuts

G 1/4  
G 1/4  
G 3/8  
G 3/8  
G 3/8  
G 3/8  
G 1/2  
G 1/2  
G 1/2  
G 1/2  
G 3/4  
G 3/4

for hose DN

4,0  
6,3  
4,0  
6,3  
8,0  
9,0  
6,3  
9,0  
11,0  
12,5  
11,0  
16,0

order no.

952057900  
952022100  
952058000  
952022200  
952028600  
952022300  
952030800  
952035200  
952022400  
952035300  
952022500  
952022600

## Nipples

connection A



DN

EN 560

- A ≙ AGS

### male connection

connection A

G 1/4 RH  
G 1/4 RH  
G 3/8 RH  
G 3/8 RH  
G 3/8 LH  
G 1/2 RH  
G 1/2 LH  
G 1/2 RH  
G 1/2 LH

for hose DN

4,0  
6,3  
6,3  
9,0  
9,0  
9,0  
9,0  
11,0  
11,0

order no.

952031000  
952027400  
952031400  
952031600  
952027200  
952031800  
952031700  
952031900  
952027000

## Screwed couplers

## male connections



| connection A | connection B | order no. |
|--------------|--------------|-----------|
| G 1/4 RH     | G 1/4 RH     | 952006000 |
| G 3/8 RH     | G 1/4 RH     | 952007200 |
| G 3/8 LH     | G 1/4 RH     | 952007100 |
| G 3/8 RH     | G 3/8 RH     | 952007000 |
| G 3/8 RH     | G 3/8 LH     | 952007300 |
| G 3/8 LH     | G 3/8 LH     | 952007400 |
| G 3/8 RH     | G 1/2 RH     | 952015800 |
| G 3/8 LH     | G 1/2 RH     | 952006900 |
| G 1/2 RH     | G 1/4 RH     | 952014200 |
| G 1/2 RH     | G 1/2 RH     | 952016700 |
| G 1/2 LH     | G 1/2 RH     | 952016800 |
| G 3/4 RH     | G 3/8 RH     | 952030300 |
| G 3/4 RH     | G 3/8 LH     | 952042800 |
| G 3/4 RH     | G 1/2 RH     | 952035700 |
| G 3/4 RH     | G 1/2 LH     | 952042700 |
| G 3/4 RH     | G 3/4 RH     | 952023700 |
| G 3/4 RH     | G 3/4 LH     | 952023600 |
| G 3/4 LH     | G 3/4 LH     | 952023500 |
| G 1 LH       | G 1 RH       | 952073600 |
| G 1 LH       | G1 LH        | 952071400 |
| G 1 RH       | G1 RH        | 952030200 |

### Male threads on both sides

EN 560

- A ≙ AGS
- B ≙ AGS

## Soldering nipple



| connection A | connection B | order no. |
|--------------|--------------|-----------|
| 12 mm        | G 3/8 RH     | 100007760 |
| 12 mm        | G 3/8 LH     | 100008760 |
| 15 mm        | G 1/2 RH     | 100009613 |
| 15 mm        | G 1/2 LH     | 100010613 |
| 16 mm        | G 1/2 RH     | 100009617 |
| 18 mm        | G 1/2 RH     | 100009612 |
| 18 mm        | G 1/2 LH     | 100010612 |
| 22 mm        | G 1/2 RH     | 100009820 |
| 22 mm        | G 1/2 LH     | 100010820 |
| 22 mm        | G 3/4 RH     | 100011612 |
| 22 mm        | G 3/4 LH     | 100012611 |
| 28 mm        | G 3/4 RH     | 100011610 |
| 28 mm        | G 3/4 LH     | 100012612 |
| 28 mm        | G 1 RH       | 100013611 |
| 28 mm        | G 1 LH       | 100014615 |
| 35 mm        | G 1 RH       | 100013616 |
| 35 mm        | G 1 LH       | 100014614 |
| 42 mm        | G 1.1/4 RH   | 100015611 |
| 42 mm        | G 1.1/4 LH   | 100016612 |

### For pipes, with nut

EN 560

- A ≙ pipe Ø
- B ≙ MG

## Screwed couplers

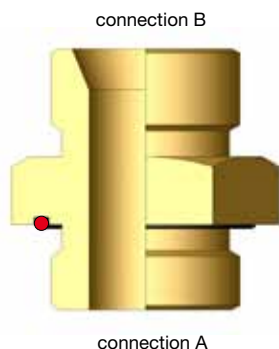

### Male thread, O-ring

EN 560

- A  $\hat{=}$  AG / O-ring
- B  $\hat{=}$  AGS

| connection A | connection B | order no.  |
|--------------|--------------|------------|
| G 1/4 RH     | G 1/4 RH     | 952095700K |
| G 1/4 RH     | G 1/4 LH     | 952095800K |
| G 1/4 RH     | G 3/8 RH     | 952122400K |
| G 1/4 RH     | G 3/8 LH     | 952068600K |
| G 3/8 RH     | G 1/4 RH     | 952059600K |
| G 3/8 RH     | G 3/8 RH     | 953138500K |
| G 3/8 RH     | G 3/8 LH     | 952133500K |
| G 3/8 RH     | G 1/2 RH     | 952103600K |
| G 3/8 RH     | G 1/2 LH     | 952046500K |
| G 3/8 RH     | G 3/4 LH     | 952106800K |
| G 3/8 RH     | G 3/4 RH     | 952130000K |
| G 1/2 RH     | G 1/4 RH     | 952014000K |
| G 1/2 RH     | G 3/8 RH     | 952014100K |
| G 1/2 RH     | G 3/8 LH     | 952013700K |
| G 1/2 RH     | G 1/2 RH     | 952013800K |
| G 1/2 RH     | G 1/2 LH     | 952013900K |
| G 1/2 RH     | G 3/4 RH     | 952017800K |
| G 1/2 RH     | G 3/4 LH     | 952017700K |
| G 1/2 RH     | G 1 RH       | 952017500K |
| G 1/2 RH     | G 1 LH       | 952017600K |
| G 3/4 RH     | G 3/8 RH     | 952050400K |
| G 3/4 RH     | G 3/8 LH     | 952064900K |
| G 3/4 RH     | G 1/2 RH     | 952049200K |
| G 3/4 RH     | G 1/2 LH     | 952026900K |
| G 3/4 RH     | G 3/4 RH     | 952015000K |
| G 3/4 RH     | G 3/4 LH     | 952014300K |
| G 3/4 RH     | G 1 RH       | 952015100K |
| G 3/4 RH     | G 1 LH       | 952020300K |
| G 1 RH       | G 3/8 RH     | 952049700K |
| G 1 RH       | G 3/8 LH     | 952049800K |
| G 1 RH       | G 1/2 RH     | 952049600K |
| G 1 RH       | G 1/2 LH     | 952016200K |
| G 1 RH       | G 3/4 RH     | 952016100K |
| G 1 RH       | G 3/4 LH     | 952016000K |
| G 1 RH       | G 1 RH       | 952015900K |
| G 1 RH       | G 1 LH       | 952036000K |
| G 1 RH       | G 1 1/4 RH   | 952048200K |
| G 1 RH       | G 1 1/4 LH   | 952048300K |
| G 1 1/4 RH   | G 1 RH       | 952073500K |
| G 1 1/4 RH   | G 1 LH       | 952093100K |
| G 1.1/4 RH   | G 1.1/4 RH   | 952073400K |
| G 1.1/4 RH   | G 1.1/4 LH   | 952070100K |
| G 1.1/4 RH   | G 1.1/2 RH   | 952101100K |
| G 1.1/2 RH   | G 1/2 RH     | 952102800K |
| G 1.1/2 RH   | G 3/4 LH     | 952046300K |
| G 1.1/2 RH   | G 1 RH       | 952038700K |
| G 1.1/2 RH   | G 1 LH       | 952036100K |
| G 1.1/2 RH   | G 1.1/4 RH   | 952028200K |
| G 1.1/2 RH   | G 1.1/4 LH   | 952023000K |
| G 1.1/2 RH   | G 1.1/2 RH   | 952060100K |

## Welding nipples



### For pipes, with nut

EN 560

- A  $\hat{=}$  pipe  $\varnothing$
- B  $\hat{=}$  MG

| connection A | connection B | order no. |
|--------------|--------------|-----------|
| 21,3 mm      | G 3/8 LH     | 100008810 |
| 21,3 mm      | G 3/8 RH     | 100007611 |
| 21,3 mm      | G 1/2 LH     | 100010610 |
| 21,3 mm      | G 1/2 RH     | 100009610 |
| 26,9 mm      | G 1/2 LH     | 100010611 |
| 26,9 mm      | G 3/4 LH     | 100012610 |
| 26,9 mm      | G 3/4 RH     | 100011611 |
| 26,9 mm      | G 1 LH       | 100014610 |
| 26,9 mm      | G 1 RH       | 100013610 |
| 33,7 mm      | G 1 LH       | 100014612 |
| 33,7 mm      | G 1 RH       | 100013614 |
| 42,0 mm      | G 1.1/4 LH   | 100016610 |
| 42,0 mm      | G 1.1/4 RH   | 100015610 |

## Male / Female couplers (O-ring)

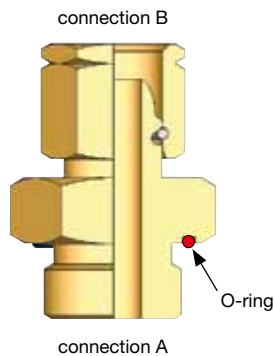

| connection A | connection B | order no.  |
|--------------|--------------|------------|
| G 1/4 RH     | G 1/4 RH     | 100005055K |
| G 1/4 RH     | G 1/4 LH     | 100005060K |
| G 1/4 RH     | G 3/8 RH     | 100107054K |
| G 1/4 RH     | G 3/8 LH     | 100008051K |
| G 3/8 RH     | G 3/8 LH     | 100008073K |
| G 3/8 RH     | G 1/2 LH     | 100010070K |
| G 3/8 RH     | G 1/2 RH     | 100009073K |
| G 3/8 RH     | G 3/8 RH     | 100207071K |
| G 1/2 RH     | G 3/8 RH     | 100007092K |
| G 1/2 RH     | G 3/8 LH     | 100008092K |
| G 1/2 RH     | G 1/2 RH     | 100009094K |
| G 1/2 RH     | G 1/2 LH     | 100010091K |
| G 1/2 RH     | G 3/4 RH     | 100111090K |
| G 1/2 RH     | G 3/4 LH     | 100012090K |
| G 1/2 RH     | G 1 RH       | 100013096K |
| G 3/4 RH     | G 1/2 RH     | 100009115K |
| G 3/4 RH     | G 1/2 LH     | 100010110K |
| G 3/4 RH     | G 3/4 RH     | 100011116K |
| G 3/4 RH     | G 3/4 LH     | 100012110K |
| G 3/4 RH     | G 1 RH       | 100013114K |
| G 3/4 RH     | G 1 LH       | 100014110K |
| G 1 RH       | G 1/2 LH     | 100010130K |
| G 1 RH       | G 3/4 RH     | 100011130K |
| G 1 RH       | G 3/4 LH     | 100012130K |
| G 1 RH       | G 1 RH       | 100013135K |
| G 1 RH       | G 1 LH       | 100014131K |
| G 1 RH       | G 1.1/4 RH   | 100015130K |
| G 1 RH       | G 1.1/4 LH   | 100016130K |

### Male thread, O-ring and nut

EN 560

- A ≙ AG / O-ring
- B ≙ MG

## Male / Female couplers

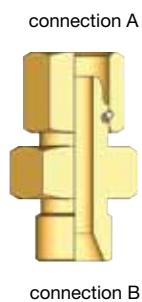

| connection A | connection B | order no. |
|--------------|--------------|-----------|
| G 1/4 RH     | G 3/8 RH     | 100005072 |
| G 1/4 RH     | G 3/8 LH     | 100005081 |
| G 3/8 RH     | G 1/4 RH     | 100107053 |
| G 3/8 RH     | G 3/8 LH     | 100007086 |
| G 3/8 LH     | G 3/8 LH     | 100108081 |
| G 3/8 RH     | G 3/8 RH     | 100007078 |
| G 3/8 LH     | G 3/8 RH     | 100008077 |
| G 3/8 RH     | G 1/2 RH     | 100007095 |
| G 3/8 RH     | G 1/2 LH     | 100007101 |
| G 3/8 LH     | G 1/2 RH     | 100008093 |
| G 3/8 LH     | G 1/2 LH     | 100008106 |
| G 1/2 RH     | G 1/2 LH     | 100009103 |
| G 1/2 RH     | G 1/4 RH     | 100009055 |
| G 1/2 RH     | G 3/8 LH     | 100009080 |
| G 3/4 RH     | G 1/2 RH     | 100011092 |
| G 1 RH       | G 3/4 RH     | 100013116 |
| G 1 RH       | G 3/4 LH     | 100013121 |
| G 1 RH       | G 1 LH       | 100013140 |

### Male thread, nut

EN 560

- A ≙ MG
- B ≙ AGS

## Cap with chain

connection A

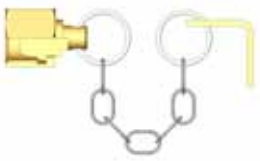

EN 560

- A ≙ MG

### connection A

| connection A | order no. |
|--------------|-----------|
| G 1/4 RH     | 100005000 |
| G 3/8 RH     | 100007000 |
| G 3/8 LH     | 100008000 |
| G 1/2 RH     | 100009000 |
| G 1/2 LH     | 100010000 |
| G 3/4 RH     | 100011000 |
| G 3/4 LH     | 100012000 |
| G 1 RH       | 100013000 |
| G 1 LH       | 100014000 |

## Distributor

connection A

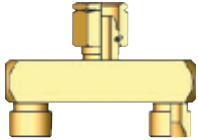

connection B

connection A

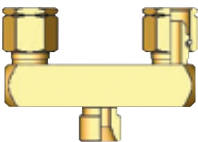

connection B

EN 560

top:

- A ≙ MG
- B ≙ AGS

lower part:

- A ≙ MG
- B ≙ AGS

### connection A

### connection B

### order no.

top:

| connection A | connection B | order no. |
|--------------|--------------|-----------|
| G 1/4 RH     | G 1/4 RH AGS | 788-003   |
| G 3/8 LH     | G 3/8 LH AGS | 788-001   |
| G 1/2 LH     | G 3/8 LH AGS | 788-005   |
| G 1/2 LH     | G 1/2 LH AGS | 788-007   |

lower part:

|          |              |         |
|----------|--------------|---------|
| G 1/4 RH | G 1/4 RH AGS | 788-004 |
| G 3/8 LH | G 3/8 LH AGS | 788-002 |
| G 1/2 LH | G 3/8 LH AGS | 788-006 |
| G 1/2 LH | G 1/2 LH AGS | 788-008 |

## WITTFIX-pipe couplers (A)



pipe

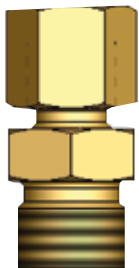

WITTFIX

nut

connection A

| pipe Ø mm | connection A | order no. |
|-----------|--------------|-----------|
| 6 x 1,0   | G 1/8 RH     | 956543800 |
| 6 x 1,0   | 1/4"-NPT     | 956659900 |
| 6 x 1,0   | G 1/4 RH     | 956580300 |
| 6 x 1,0   | G 3/8 RH     | 956544100 |
| 8 x 1,0   | G 1/8 RH     | 956567300 |
| 8 x 1,0   | 1/4"-NPT     | 956618500 |
| 8 x 1,0   | G 1/4 RH     | 956543900 |
| 8 x 1,0   | G 3/8 RH     | 956565900 |
| 8 x 1,0   | G 1/2 RH     | 956676100 |
| 10 x 1,0  | 1/4"-NPT     | 956596400 |
| 10 x 1,0  | G 1/4 RH     | 956528200 |
| 10 x 1,0  | 3/8"-NPT     | 956673500 |
| 10 x 1,0  | G 3/8 RH     | 956532000 |
| 10 x 1,0  | G 1/2 RH     | 956559000 |
| 12 x 1,0  | 1/4"-NPT     | 956596500 |
| 12 x 1,0  | G 1/4 RH     | 956551900 |
| 12 x 1,0  | G 3/8 RH     | 956743700 |
| 12 x 1,0  | 1/2"-NPT     | 956553200 |
| 12 x 1,0  | G 1/2 RH     | 956544300 |
| 15 x 1,0  | 3/8"-NPT     | 956678400 |
| 15 x 1,0  | 1/2"-NPT     | 956678200 |
| 15 x 1,0  | G 1/2 RH     | 956657700 |
| 22 x 1,0  | G 1 RH       | 956657800 |

For copper- or stainless steel pipes  
max. 25 bar/362 psi working pressure

EN 560

- A ≙ AG
- containing: nut, O-ring, pressure ring, screwed coupler, cap nut

## WITTFIX-pipe couplers (A/B)



| pipe Ø mm | connection A | connection B | order no. |
|-----------|--------------|--------------|-----------|
| 6 x 1,0   | G 1/4 RH     |              | 956725400 |
| 6 x 1,0   | G 3/8 LH     |              | 956659700 |
| 6 x 1,0   | G 3/8 RH     |              | 956725500 |
| 6 x 1,0   |              | G 1/4 RH     | 956745700 |
| 6 x 1,0   |              | G 3/8 LH     | 956659600 |
| 6 x 1,0   |              | G 3/8 RH     | 956741800 |
| 8 x 1,0   | G 1/4 RH     |              | 956753600 |
| 8 x 1,0   | G 3/8 LH     |              | 956723700 |
| 8 x 1,0   | G 3/8 RH     |              | 956746300 |
| 8 x 1,0   | G 1/2 LH     |              | 956725700 |
| 8 x 1,0   | G 1/2 RH     |              | 956725600 |
| 8 x 1,0   |              | G 1/4 RH     | 956746200 |
| 8 x 1,0   |              | G 3/8 LH     | 956740100 |
| 8 x 1,0   |              | G 3/8 RH     | 956623000 |
| 8 x 1,0   |              | G 1/2 LH     | 956753900 |
| 8 x 1,0   |              | G 1/2 RH     | 956754000 |
| 10 x 1,0  | G 1/4 RH     |              | 956753700 |
| 10 x 1,0  | G 3/8 LH     |              | 956725800 |
| 10 x 1,0  | G 3/8 RH     |              | 956725900 |
| 10 x 1,0  | G 1/2 LH     |              | 956726100 |
| 10 x 1,0  | G 1/2 RH     |              | 956726000 |
| 10 x 1,0  |              | G 1/4 RH     | 956648100 |
| 10 x 1,0  |              | G 3/8 LH     | 956753400 |
| 10 x 1,0  |              | G 3/8 RH     | 956718100 |
| 10 x 1,0  |              | G 1/2 LH     | 956754900 |
| 10 x 1,0  |              | G 1/2 RH     | 956755000 |
| 12 x 1,0  | G 1/4 RH     |              | 956755100 |
| 12 x 1,0  | G 3/8 LH     |              | 956677400 |
| 12 x 1,0  | G 3/8 RH     |              | 956717900 |
| 12 x 1,0  | G 1/2 LH     |              | 956726400 |
| 12 x 1,0  | G 1/2 RH     |              | 956726300 |
| 12 x 1,0  |              | G 1/4 RH     | 956754800 |
| 12 x 1,0  |              | G 3/8 LH     | 956668600 |
| 12 x 1,0  |              | G 3/8 RH     | 956717100 |
| 12 x 1,0  |              | G 1/2 LH     | 956697500 |
| 12 x 1,0  |              | G 1/2 RH     | 956697600 |
| 15 x 1,0  | G 3/8 LH     |              | 956678900 |
| 15 x 1,0  | G 3/8 RH     |              | 956678500 |
| 15 x 1,0  | G 1/2 LH     |              | 956679100 |
| 15 x 1,0  | G 1/2 RH     |              | 956678700 |
| 15 x 1,0  |              | G 3/8 LH     | 956679000 |
| 15 x 1,0  |              | G 3/8 RH     | 956678600 |
| 15 x 1,0  |              | G 1/2 LH     | 956679200 |
| 15 x 1,0  |              | G 1/2 RH     | 956678800 |

For the integration of a safety device into the copper- or stainless steel pipelines

max. 25 bar/362 psi working pressure

thread-connection: EN 560

- A ≙ AGS
- B ≙ MG

## Types of threads:



**IG** -  
simple  
female thread



**AG** -  
simple  
male thread

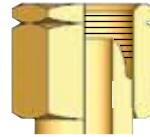

**MG** -  
female thread with ball head,  
metallic self-sealing



**AGS** -  
male thread with  
counterbore

## Turning of threads:

**RH** right-handed

**LH** left-handed

## You have questions?

## We provide you with qualified answers!

Tel: +49 (02302) 8901-0

Fax: +49 (02302) 8901-3

[www.wittgas.com](http://www.wittgas.com)

[witt@wittgas.com](mailto:witt@wittgas.com)